

Assembling FSB ASL® for lock "Assa"



Image 1
Tools required when
assembling FSB ASL®.



Image 2
Inserting the drilling template
for lock "Assa".



Image 3
Lining the drilling template
up: parallel with the edge of
the door.



Image 4
Drilling from the righthand side
of the door. Drill through the
top righthand bushing on the
drilling template. Important: do
not drill into the lock case.

Assembling FSB ASL® for lock "Assa"



Image 5
Drilling from the righthand side of the door. Drill through the bottom lefthand bushing on the drilling template. Important: do not drill into the lock case.



Image 6
Completed boreholes on the righthand side of the door.



Image 7
Drilling from the lefthand side of the door. Drill through the top lefthand bushing on the drilling template. Important: do not drill into the lock case.



Image 8
Drilling from the lefthand side of the door. Drill through the bottom righthand bushing on the drilling template. Important: do not drill into the lock case.

Assembling FSB ASL[®] for lock "Assa"



Image 9
Completed boreholes on the
lefthand side of the door.



Image 10
Fitting the spindle from the
lefthand side of the door. Make
a careful note of the position
of the notch; cf. area marked
in red in the figure. Slot on the
FSB ASL[®] baserose, pointing
it in the direction of the forend
as shown.



Image 11
Slot on the FSB ASL[®] baserose
on the righthand side of the
door, pointing it in the direc-
tion of the forend as shown.



Image 12
Insert and tighten the screws
supplied from the righthand
side of the door. On the left-
hand side, use the other hand
as a means of holding the
bearing in position. The sleeves
are fitted from the lefthand
side.

Assembling FSB ASL[®] for lock "Assa"



Image 13
Ensure the spindle is positioned centrally.

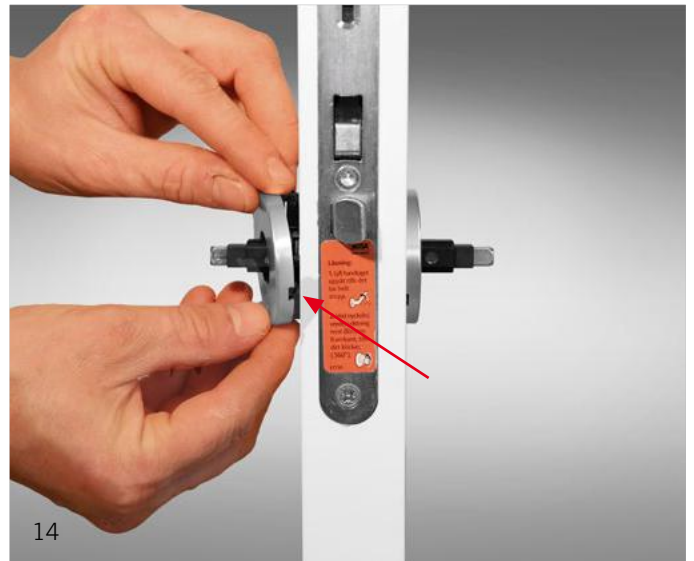

Image 14
Clip on the lefthand cover rose.



Image 15
Clip on the righthand cover rose.



Image 16
Slip on the FSB ASL[®] female handle sections. Insert grub screws on either side.

Assembling FSB ASL[®] for lock "Assa"



Image 17
Use an Allen key to tighten the righthand grub screw.



Image 18
Use an Allen key to tighten the lefthand grub screw.

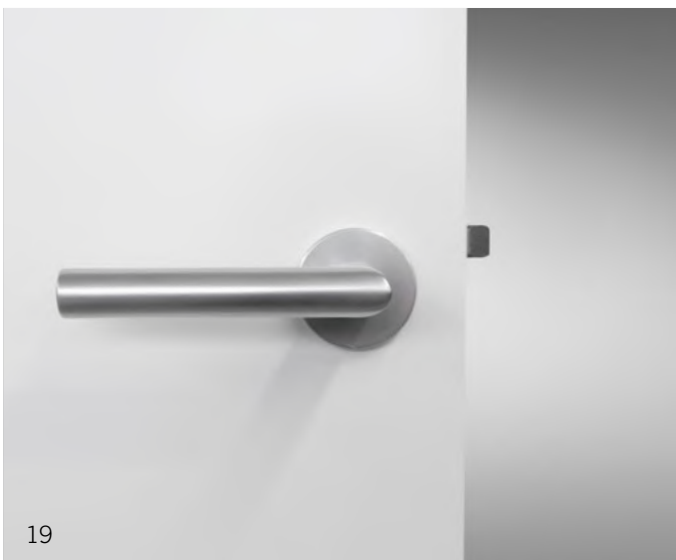

Image 19
Final horizontal position of the handle.